

DRYVIT FEDDERLITE & OUTSULITE

Prefabricated Exterior Insulation & Finishing Systems

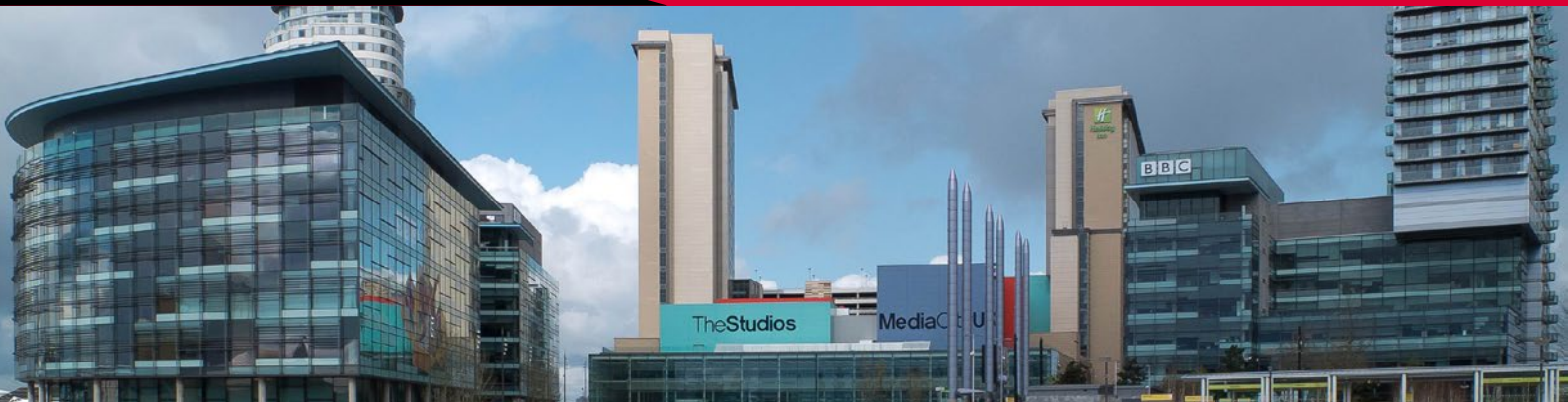

System Overview

Dryvit's Fedderlite and Outsulite are prefabricated exterior insulation and finishing systems (EIFS) offering fast track installation for use on either new construction or refurbishment projects. Like site applied Outsulation these prefabricated systems are based on a simple premise...insulation is more effective when placed on the exterior of a building.

By bringing insulation to the outside of external walls, these prefabricated panelised EIFS eliminate thermal bridges; stabilise interior environments; minimise thermal shock; and build upon the proven weatherability of Outsulation.

In construction, time means money. The faster your building is completed, the earlier it can be occupied and your revenue stream can start. Ultimately these systems enable building owners to determine more accurate project costing based on defined parameters.



Benefits

- **Fast track.** The panel systems enable rapid installation unhindered by environmental conditions that would normally affect traditional building methods. Panels can be installed off mast climbers or mobile towers, reducing access time and cost.
- **Design freedom.** Both systems can be installed over a variety of substrates. Expanded polystyrene (EPS) insulation is lightweight and can be cut or grooved to various shapes and surface patterns.
- **Energy efficiency.** Fedderlite and Outsulite enable new or existing buildings to meet strict energy efficiency requirements. Heating or cooling costs are demonstrably lower in lieu of other exterior materials.
- **Lightweight.** Panels weigh less than brick, stone or precast concrete thus they limit imposed loading on existing and new build structures. Despite their lightweight nature the panels are capable of withstanding critical wind and structural loads.
- **Versatile.** Dimensional adjustments can be made easily and inexpensively right up to panel assembly time. Of great advantage in retrofit or new build projects.
- **Weatherability.** Dryvit systems are formulated to provide the utmost in weather protection providing a resilient barrier against the elements.
- **Durability.** The combination of system components provide unsurpassed long-term durability meeting design requirements for use in virtually any location.
- **Aesthetics.** Dryvit finishes are available in a wide array of textures in both standard and custom colours. Our speciality finishes enable designers to replicate a variety of real stone or brick finishes from limestone to granite at a fraction of the cost.
- **Cost effective.** Fedderlite and Outsulite are adaptable to complex project details. Installation is rapid, and routine maintenance is minimal.
- **Testing.** Independently certified by international test bodies. Dryvit manufacturing plants are ISO 9001 certified, demonstrating the highest standards of quality and consistency.



DRYVIT FEDDERLITE SYSTEM

A prefabricated EIFS panel system incorporating EPS 70E grade expanded polystyrene (EPS) insulation. A drainage cavity can be accommodated in the system if called for in the specification.

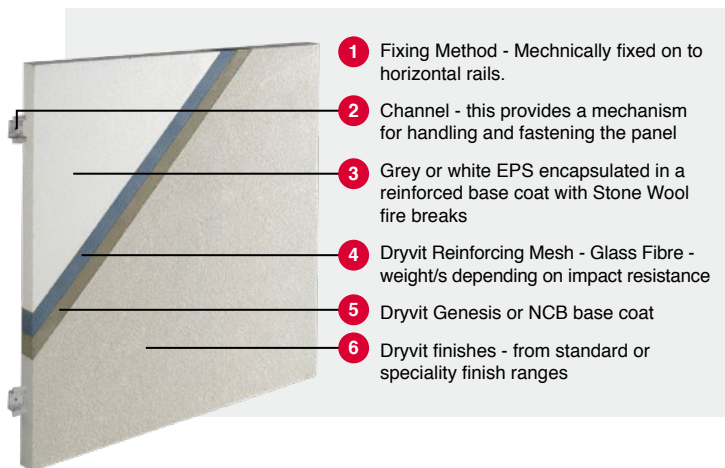

DRYVIT OUTSULITE CONVENTIONAL PANEL

A prefabricated EIFS whole wall panel system incorporating a lightweight structural steel stud frame, sheathing and EPS 70E grade expanded polystyrene (EPS) or stone wool insulation.

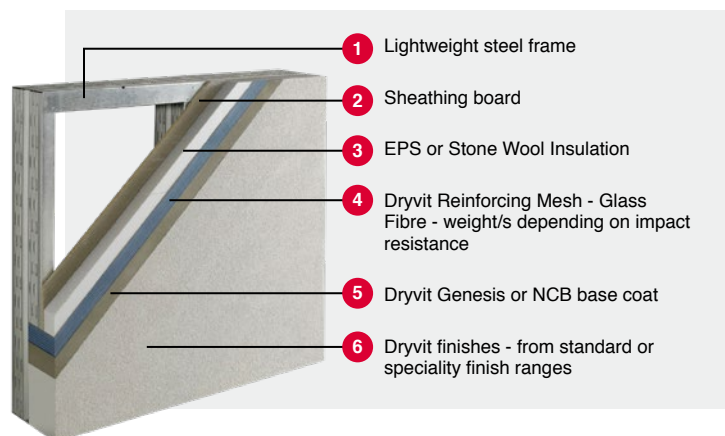

SUBSTRATE TYPES

Fedderlite panels can be installed on sheathings over steel or timber frame structures and may be fixed adhesively and/or mechanically fastened. The panels can also be installed over in-situ concrete, pre-cast concrete, blockwork, brick, render, Wimpey No-fines, and exposed aggregate panels.

Outsulite whole wall panels can be connected to structural steel or concrete frame structures from inside the building by welding, bolting, mechanical fasteners or a combination of fixing methods.

For guidance on substrate tolerances and the correct fixing method to withstand the thermal stresses and wind loads to satisfy BS EN 1991-1-4 and BS EN 1990, please consult Dryvit UK Ltd.

APPLICATION

Application of the systems are carried out by Specialist Installers employing operatives who have been trained in the use of Dryvit materials. In addition Dryvit are committed to providing on site support to their network of Specialist Installers when called upon. Details of recommended Specialist Installers are available from Dryvit UK Ltd.

DRYVIT UK LTD

Unit 4 Wren Park, Hitchin Road,
Shefford, Bedfordshire SG17 5JD
Tel: 01462 819555 Fax: 01462 819556
Email: uqenquiries@dryvit.com www.dryvit.co.uk
©Dryvit UK Ltd. 2019

THERMAL PERFORMANCE

U-value and condensation risk calculations are carried out by Dryvit upon request to ensure that the correct thickness of insulation is specified for each project to meet target requirements. U-values calculations can then be incorporated within the buildings target SAP calculation.

Thermal resistivity values of insulation

White expanded polystyrene - 0.038 W/mK

Grey expanded polystyrene - 0.031 or 0.032 W/mK

Stone wool - 0.036 - 0.040 W/mK

STANDARD DETAILS

Standard details are available for both Fedderlite and Outsulite systems and can be downloaded from www.dryvit.co.uk.

Dryvit offers a CAD service to produce bespoke details in line with specific project needs.

FINISHES

Dryvit 100% acrylic finishes contain aggregates of various sizes and use Proven Mildew Resistance (PMR) chemistry and are offered as standard with the Outsulation System. HDP finishes are also available which incorporates hydrophobic technology to repel water, resulting in less dirt pick up, a cleaner wall appearance and lower maintenance. The standard finish range is available in six different textures with over 360 chart colours to select from. If your desired colour is not available from our standard finish range then we have a colour matching service that will be sure to satisfy your requirements.

Dryvit's range of Speciality Finishes enable designers to achieve various effects, like the look of granite in many shades, brickwork, wood, concrete and stone providing a lightweight equivalent to their natural alternative at a fraction of the cost.

STANDARD TEXTURE RANGE



SPECIALITY FINISHES



WARRANTY



- Standard 10 Year "Dryvit Warranty" available on all projects upon written request.
- 10 Year third party insurance backed warranties covering materials and installation - extended periods available.
- 'Back to Back' warranties available on request from partnering material suppliers and installers.

For more information on warranties please contact Dryvit UK Ltd. or visit our web site www.dryvit.co.uk

